

SI Rod end SIL20-T-K-DURBAL - SIL20-T-K-DURBAL

<https://www.123bearing.eu/bearing-housing/rod-end/si/sil20-t-k-durbal>

SIL20-T-K



female thread:
maintenance free,
according to
DIN ISO 12240-4,
series K



Description: DIN ISO rod end K series. Made of spherical plain bearing DG...PW pressed into rod end body. Sliding combination steel / bronze-PTFE composite.

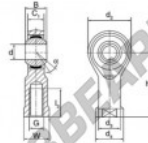

Rod end body:
surface zinc plated

Sliding combination:
steel / bronze-PTFE composite

Inner ring:
bearing steel, hardened, ground and
spherical surface chromium plated

Outer ring:
brass body pressed around, outer race
lined with bronze-PTFE composite

Lubrication:
maintenance free

order number	right hand thread	left hand thread	d	G	B	C ₁	d ₂	d ₃	d ₄
SIL 20 T/K			20	M 20 x 1,5	25	18,00	50	27,5	34

type	measurement (mm)			d ₁	load rating C ₁₀ (N)	weight (kg)
	l ₁ min	W	h			
SI / SIL 20 T/K	33	30	77	14	57,0	0,420

PRODUCT FEATURES

Brand	DURBAL
N° Ean13	3663952489568
Inside diameter	20 mm
Outside diameter	50 mm
Thickness	25 mm
Type	SI
Weight	420 g
Thread	Left-hand thread
Lubrication	without
Packaging	1

contact@123bearing.eu

+33 359 36 04 90

CRT4 de Lesquin 60 Rue Du Haut De Sainghin 59273 Fretin FRANCE