

**TPN Rod end**  
**GK15-DO-DURBAL - GK15-DO-DURBAL**  
<https://www.123bearing.eu/bearing-housing/rod-end/tpn/gk15-do-durbal>

**GK15-DO**



**Description:** DIN ISO Hydraulic rod end with welding slope and dowel pin at the end of rod. Made of spherical plain bearing DGE... ES (ES-2RS) pressed into rod end housing. Sliding combination steel / steel.  
Type DGK...DO-2RS with two additional seals available on request with grease nipple.

hydraulic rod ends, according to DIN ISO 12240-4, series E

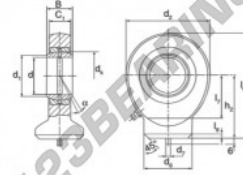

**Sliding combination:** steel / steel

**Inner ring:** bearing steel, hardened, ground and phosphated

**Outer ring:** bearing steel, hardened, ground and phosphated

**Lubrication:** lubrication required

\* without grease nipple  
\*\* with grease nipple

order number	d	d <sub>1</sub>	d <sub>2</sub>	measurement [mm]			B	C <sub>1</sub>
<b>GK 15 DO**</b>	15	18,4	40	4	21,0	12	10	

type	h <sub>1</sub>	l <sub>1</sub>	measurement [mm]		D	d <sub>4</sub>	α	load rating	weight
			l <sub>2</sub>	l <sub>3</sub>			[°]	C <sub>0</sub> [kN]	[kg]
<b>GK 15 DO**</b>	31	51,0	20,0	2,0	26	22,0	8	32,0	0,120

**PRODUCT FEATURES**

Brand	DURBAL
N° Ean13	3663952501321
Inside diameter	15 mm
Outside diameter	40 mm
Thickness	12 mm
Type	-
Weight	120 g
Lubrication	-
Packaging	-
Standard	-

[contact@123bearing.eu](mailto:contact@123bearing.eu)

+33 359 36 04 90

CRT4 de Lesquin 60 Rue Du Haut De Sainghin 59273 Fretin FRANCE