

SA Rod end BEM10-20-501-DURBAL - BEM10-20-501-DURBAL

<https://www.123bearing.eu/bearing-housing/rod-end/sa/bem10-20-501-durbal>

BEM10-20-501



male thread:
maintenance free,
adapter sizes
according to
DIN ISO 12240-4,
series K



**DURBAL® heavy-duty rod ends
with integral spherical
plain bearing**

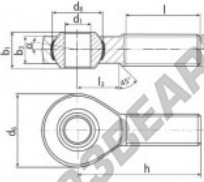

rod end housing:
forged steel, tempered, rolled thread,
surface galvanized, free of Cr-VI

joint ball:
ball bearing steel, hardened and ground,
surface superfinished and chromium
plated

race:
nylon / teflon / glass fibre compound

tolerances:
see page 10

order number		measurements [mm]		weight		basic load rating	
type	right-hand thread / left-hand thread	d ₁	d ₂	d ₃	d ₄	b ₁	b ₂
BEM 10 -20 -501		10	M 10	28	19,00	14	10,5
measurements [mm]		weight		basic load rating			
type	h	l	l ₃	α ₁ °	α ₂ °	d _{ym}	stat. C [N]
BEM 10	48	29	15	13,5	8,0		

PRODUCT FEATURES

Brand	DURBAL
N° Ean13	3663952507811
Inside diameter	10 mm
Outside diameter	28 mm
Thickness	14 mm
Type	SA
Weight	60 g
Thread	Right-hand thread
Lubrication	without
Packaging	1

contact@123bearing.eu

+33 359 36 04 90

CRT4 de Lesquin 60 Rue Du Haut De Sainghin 59273 Fretin FRANCE