

SI Rod end BEF10-20-502-DURBAL - BEF10-20-502-DURBAL

<https://www.123bearing.eu/bearing-housing/rod-end/si/bef10-20-502-durbal>

BEF10-20-502



rod end housing:
forged steel, tempered, surface galvanized, free of Cr-VI

joint ball:
ball bearing steel, hardened and ground, surface superfinished and chromium plated

race:
nylon / teflon / glass fibre compound

tolerances:
see page 10

DURBAL® heavy-duty rod ends with integral spherical plain bearing

female thread:
maintenance free, adapter sizes according to DIN ISO 12240-4, series K, thread according to ISO 8139

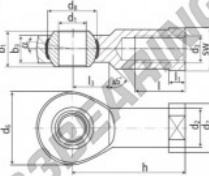

order number		measurements [mm]											
type	spec. hard thread	spec. hard thread	d ₁	d ₂	d ₃	d ₄	d ₅	d ₆	d ₇	d ₈	b ₁	b ₂	b ₃
BEF 10	-20	-502	10	15,0	M 10	28	19	19,00	14	10,5			
measurements [mm]		weight											
type	h	l	l ₁	l ₂	l ₃	SW	α ₁ [°]	α ₂ [°]	weight [kg]	basic load rating dyn. stat.			
BEF 10	43	20	6,5	15	17		13,5	8,0	0,074	10420	27400		

PRODUCT FEATURES

Brand	DURBAL
N° Ean13	3663952508078
Inside diameter	10 mm
Outside diameter	28 mm
Thickness	14 mm
Type	-
Weight	74 g
Thread	-
Lubrication	-
Packaging	-

contact@123bearing.eu

+33 359 36 04 90

CRT4 de Lesquin 60 Rue Du Haut De Sainghin 59273 Fretin FRANCE