

SI Rod end BEF16SO-21-501-DURBAL - BEF16SO-21-501-DURBAL

<https://www.123bearing.eu/bearing-housing/rod-end/si/bef16so-21-501-durbal>

BEF16SO-21-501



rod end housing:
forged steel, tempered, surface galvanized, free of Cr-VI

joint ball:
ball bearing steel, hardened and ground, surface superfinished and chromium plated

race:
nylon / teflon / glass fibre compound

tolerances:
see page 10

DURBAL® heavy-duty rod ends with integral spherical plain bearing

female thread:
maintenance free, adapter sizes according to DIN ISO 12240-4, series K, thread according to ISO 8139

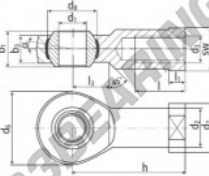

order number		measurements [mm]									
type	right-hand thread	d ₁	d ₂	d ₃	d ₄	d ₅	d ₆	d ₇	d ₈	b ₁	b ₂
BEF 16 SO -21	-501	16	22,0	M 16 x 1,5	42	27	28,52	21	15,0		
measurements [mm]		weight									
type	h	l	l ₁	l ₂	SW	α ₁ ¹ [°]	α ₂ ² [°]	weight [kg]		basic load rating	
BEF 16 SO	64	28	8,0	22	22	15,5	8,5	0,233		22410 59600	

PRODUCT FEATURES

Brand	DURBAL
N° Ean13	3663952508160
Inside diameter	16 mm
Inside diameter	0.63" inch
Outside diameter	42 mm
Outside diameter	1.654" inch
Thickness	21 mm
Thickness	0.827" inch
Type	SI
Weight	233 g
Thread	Right-hand thread
Lubrication	without
Packaging	1

contact@123bearing.eu

+33 359 36 04 90

CRT4 de Lesquin 60 Rue Du Haut De Sainghin 59273 Fretin FRANCE