

## SI Rod end EF15-20-502-DURBAL - EF15-20-502-DURBAL

<https://www.123bearing.eu/bearing-housing/rod-end/si/ef15-20-502-durbal>

EF15-20-502



rod end housing:  
forged steel, tempered, surface galvanized, free of Cr VI

joint ball:  
ball bearing steel, hardened and ground, surface superfinished and chromium plated

race:  
nylon / teflon / glass fibre compound

tolerances:  
see page 10

**DURBAL® heavy-duty rod ends with integral spherical plain bearing**

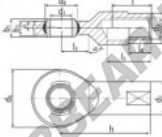

female thread:  
maintenance free, adapter sizes according to DIN ISO 12240-4, series E / EH



order number		measurements [mm]																
type	right-hand thread	d <sub>1</sub>	d <sub>2</sub>	d <sub>3</sub>	d <sub>4</sub>	d <sub>5</sub>	d <sub>6</sub>	d <sub>7</sub>	d <sub>8</sub>	b <sub>1</sub>	b <sub>2</sub>	b <sub>3</sub>	b <sub>4</sub>	b <sub>5</sub>	b <sub>6</sub>	b <sub>7</sub>	b <sub>8</sub>	h
EF 15	-20	-502	15	22	M 14	38	22,0	12	9	61								
measurements [mm]		weight										basic load rating						
type	l	l <sub>3</sub>	l <sub>4</sub>	l <sub>5</sub>	SW	α <sub>1</sub> <sup>1</sup> [°]	α <sub>2</sub> <sup>1</sup> [°]	kg	C		C <sub>0</sub>							
EF 15	25	18			19	8,5	4,5	0,142	13400		41000							

### PRODUCT FEATURES

Brand	DURBAL
N° Ean13	3663952508436
Inside diameter	15 mm
Inside diameter	0.591" inch
Outside diameter	38 mm
Outside diameter	1.496" inch
Thickness	12 mm
Thickness	0.472" inch
Type	SI
Weight	142 g
Thread	Left-hand thread
Lubrication	without
Packaging	1

[contact@123bearing.eu](mailto:contact@123bearing.eu)

+33 359 36 04 90

CRT4 de Lesquin 60 Rue Du Haut De Sainghin 59273 Fretin FRANCE