

## SA Rod end BEM14-60-502-DURBAL - BEM14-60-502-DURBAL

<https://www.123bearing.eu/bearing-housing/rod-end/sa/bem14-60-502-durbal>

### BEM14-60-502



male thread;  
maintenance free,  
adapter sizes  
according to  
DIN ISO 12240-4,  
series K



**DURBAL® heavy-duty rod ends  
with integral spherical  
plain bearing in stainless steel**

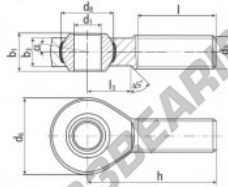

rod end housing:  
stainless steel 1.4301, rolled thread,  
surface with pickling treatment

joint ball:  
stainless steel, hardened and ground,  
surface superfinished

race:  
nylon / teflon / glass fibre compound

tolerances:  
see page 10

order number		measurements [mm]						
type	right-hand thread	left-hand thread	d <sub>1</sub>	d <sub>2</sub>	d <sub>3</sub>	h <sub>1</sub>	h <sub>2</sub>	
BEM 14	-60	-502	14	M 14	36	25,35	19	13,5
type		measurements [mm]			weight	basic load rating		
h	l	l <sub>1</sub>	α <sub>1</sub> [°]	α <sub>2</sub> [°]	[kg]	dyn. C [N]	stat. C <sub>0</sub> [N]	
BEM 14	60	36	20	16,0	9,5	0,127	9480	27600

## PRODUCT FEATURES

Brand	DURBAL
N° Ean13	3663952509778
Inside diameter	14 mm
Outside diameter	36 mm
Thickness	19 mm
Type	SA
Weight	127 g
Thread	Left-hand thread
Lubrication	without
Packaging	1

[contact@123bearing.eu](mailto:contact@123bearing.eu)

+33 359 36 04 90

CRT4 de Lesquin 60 Rue Du Haut De Sainghin 59273 Fretin FRANCE