

SI Rod end BEF3-8-20-502-DURBAL - BEF3-8-20-502-DURBAL

<https://www.123bearing.eu/bearing-housing/rod-end/si/bef3-8-20-502-durbal>

BEF3/8-20-502



rod end housing:
forged steel, tempered, surface galvanized, free of Cr VI

joint ball:
ball bearing steel, hardened and ground, surface superfinished and chromium plated

race:
nylon / teflon / glass fibre compound

tolerances:
see page 10

DURBAL® heavy-duty rod ends with integral spherical plain bearing

female thread:
maintenance free, dimensions in inches

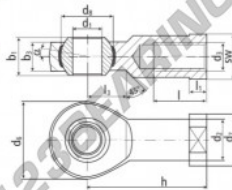

order number		measurements [inches]										
type	right hand thread	left hand thread	d ₁	d ₂	d ₃	d ₄	d ₅	d ₆	d ₇	d ₈	b ₁	b ₂
BEF	3/8 - 20	-502	.375	.567	.3750-24 UNF	1.000	.689	.719	.499	.405		
		measurements [inches]										
type	h	l	l ₁	l ₂	SW	α ₁ [°]	α ₂ [°]	l _q	weight	basic load rating	stat. C ₀ [N]	stat. C ₁₀ [N]
BEF	3/8	1.641	.874	.275	.503	.570	9.5	5.5	0.059	7650	20300	

PRODUCT FEATURES

Brand	DURBAL
N° Ean13	3663952510545
Inside diameter	9.53 mm
Outside diameter	25.4 mm
Thickness	12.67 mm
Type	SI
Weight	59 g
Thread	Left-hand thread
Lubrication	without
Packaging	1

contact@123bearing.eu

+33 359 36 04 90

CRT4 de Lesquin 60 Rue Du Haut De Sainghin 59273 Fretin FRANCE