

SI Rod end

BEF1-2-20-502-DURBAL - BEF1-2-20-502-DURBAL

<https://www.123bearing.eu/bearing-housing/rod-end/si/bef1-2-20-502-durbal>

BEF1/2-20-502



rod end housing:
forged steel, tempered, surface galvanized, free of Cr VI

joint ball:
ball bearing steel, hardened and ground, surface superfinished and chromium plated

race:
nylon / teflon / glass fibre compound

tolerances:
see page 10

DURBAL® heavy-duty rod ends with integral spherical plain bearing

female thread:
maintenance free, dimensions in inches

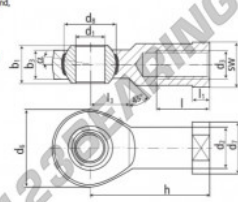

order number		measurements [inches]										
type	right hand thread	left hand thread	d ₁	d ₂	d ₃	d ₄	d ₅	d ₆	d ₇	d ₈	b ₁	b ₂
BEF 1/2 -20	-502		.500	.748	.5000-20 UNF	1.311	.874	.876	.824	.472		
		measurements [inches]										
type	h	l	l ₁	l ₂	SW	α ₁ [°]	α ₂ [°]	l _q	weight	basic load rating	stat. C ₀ [N]	stat. C ₁₀ [N]
BEF 1/2	2.145	1.161	.279	.649	.757	13.0	9.5	0.127	14649	39000		

PRODUCT FEATURES

Brand	DURBAL
N° Ean13	3663952510576
Inside diameter	12.7 mm
Outside diameter	33.3 mm
Thickness	15.85 mm
Type	SI
Weight	127 g
Thread	Left-hand thread
Lubrication	without
Packaging	1

contact@123bearing.eu

+33 359 36 04 90

CRT4 de Lesquin 60 Rue Du Haut De Sainghin 59273 Fretin FRANCE